

# WingSpan™ Wall Stand Off

## INSTRUCTIONS



If you need any assistance with these instructions,  
please call our Customer Experience Team at  
800-453-1192.

### Components

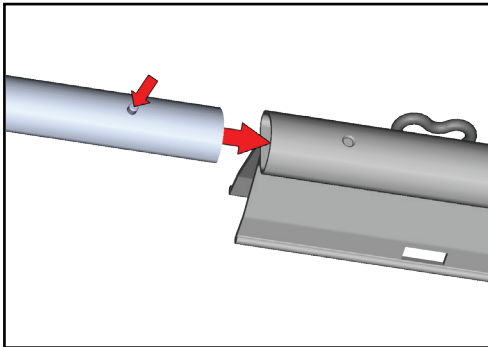
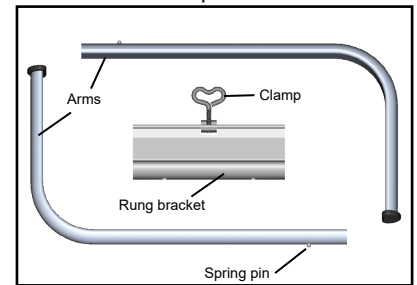

To assemble, hold down the spring pins and slide the arms into the rung bracket until the spring pins lock into place.

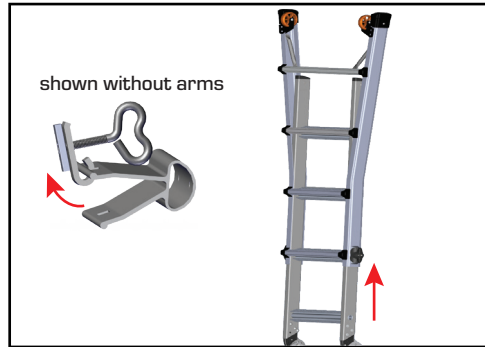

Make sure the clamp is swung out of the way, and the outer assembly on the ladder is extended at least one rung.

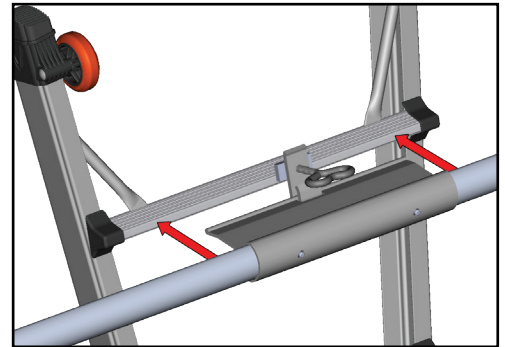

Slide the rung bracket onto the top outer rung as shown above. The rung bracket should sit at 90 degree angle as shown in the image below.

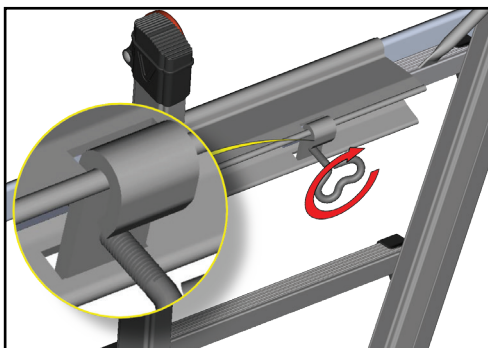

Swing the clamp around and hook it into the open slot in the rung bracket, then tighten the clamp onto the rung. If the clamp will not reach the slot, loosen the clamp all the way, and then try again. Make sure the WingSpan™ is secure before each use.



Your WingSpan wall standoff is now ready to use

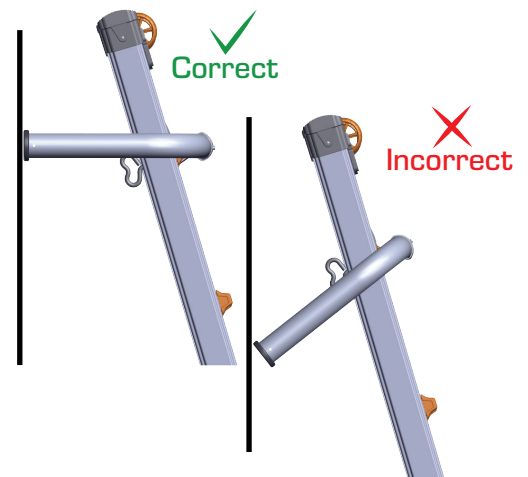

# WingSpan™ Wall Stand Off

## INSTRUCTIONS

**WARNING: Use only in approved positions.**  
**Use in any other positions may result in serious injury or death.**

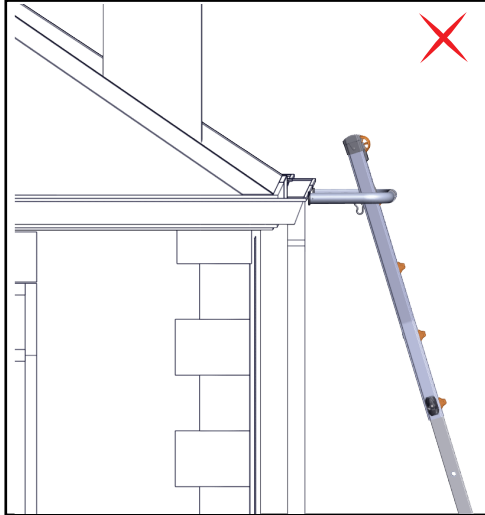
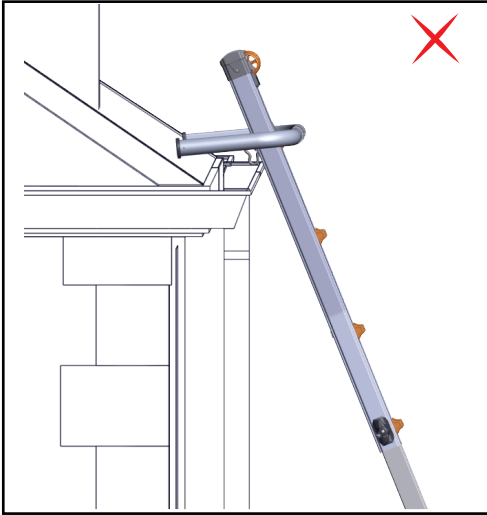

**Do not rest arms on roof**  
**Do not rest on rain gutters**  
**Do not use on uneven or sloped surfaces**

**Always keep arms perpendicular to wall/surface**

**Make sure ladder is properly set up on an even surface**

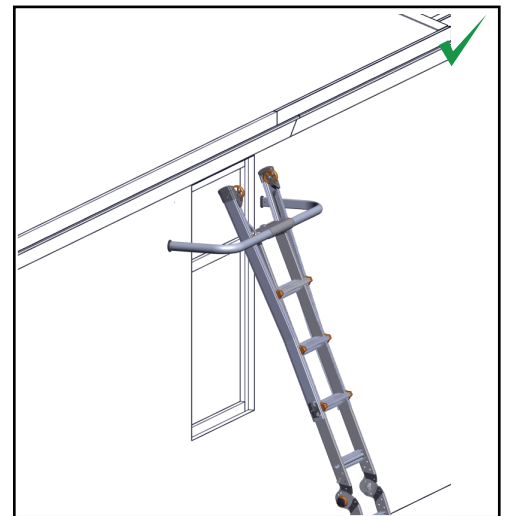
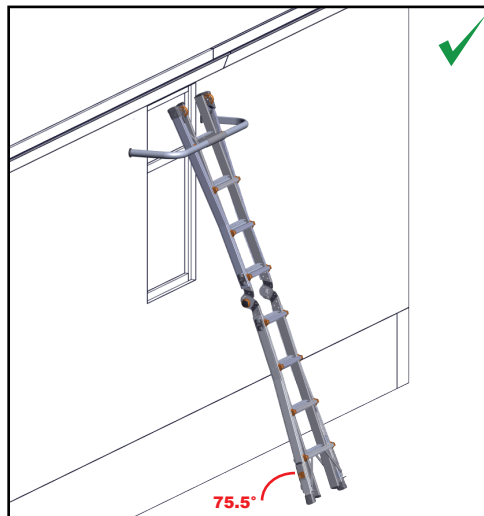

**Little Giant Ladder Systems, LLC.**

1198 North Spring Creek Place

Springville, UT 84663

Toll Free: 800-453-1192

Phone: 801-489-3684

Fax: 801-489-3685

[www.LittleGiantLadders.com](http://www.LittleGiantLadders.com)

